

Fittings

Tee With Straight End

SEALING SYSTEMS

Nominal Size DN	A	L	T	Ordering Code
10	13	26	1.5	010000-400-D* **
15	19	35	1.5	015000-400-D* **
20	23	40	1.5	020000-400-D* **
25	29	50	1.5	025000-400-D* **
32	35	55	1.5	032000-400-D* **
40	41	60	1.5	040000-400-D* **
50	53	70	1.5	050000-400-D* **
65	70	80	2.0	065000-400-D* **
80	85	90	2.0	080000-400-D* **
100	104	100	2.0	100000-400-D* **
125	129	187.5	2.0	125000-400-D* **
150	154	225	2.0	150000-400-D* **
200	204	300	2.0	200000-400-D* **

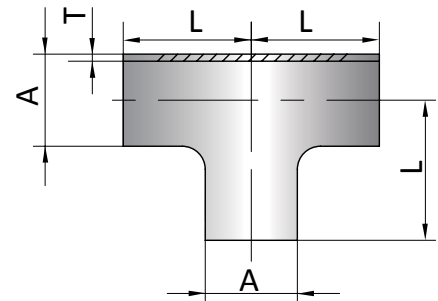

* The first digit refers to material guide, according to Table 1
 ** The last digit refers to surface quality, according to Table 2

Table 1

Material Guide	
1.4301 (304)	1
1.4307 (304L)	2
1.4401 (316)	3
1.4404 (316L)	4

Table 2

Inside Surface	Outside Surface	Ordering Code
No finish requirement	No finish requirement	u
MP* 30μ-in 0.80μm	No finish requirement	0
MP* 30μ-in 0.80μm	MP* 30μ-in 0.80μm	3
MP* 20μ-in 0.51μm	MP* 30μ-in 0.80μm	4
MP* 12μ-in 0.30μm	MP* 30μ-in 0.80μm	7
MP* 9μ-in 0.23μm	MP* 30μ-in 0.80μm	8
Mirror	MP* 30μ-in 0.80μm	9

*MP: Mechanically Polished

Ordering Example

Description	Nominal Size DN	Ordering Code
Type 400	25	025000-400-D63*

*Material and Surface are including to the ordering code

Fittings

Tee With Straight End

SEALING SYSTEMS

Nominal Size DN	A	L	T	Ordering Code
10	12	26	1.5	010000-402-D* **
15	18	35	1.5	015000-402-D* **
20	22	40	1.5	020000-402-D* **
25	28	50	1.5	025000-402-D* **
32	34	55	1.5	032000-402-D* **
40	40	60	1.5	040000-402-D* **
50	52	70	1.5	050000-402-D* **

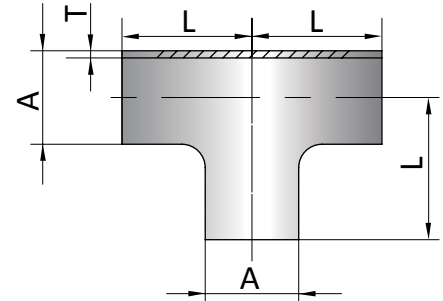

* The first digit referse to material guide, according to Table 1

** The last digit referse to surface quality, according to Table 2

Table1

Material Guide	
1.4301 (304)	1
1.4307 (304L)	2
1.4401 (316)	3
1.4404 (316L)	4

Table 2

Inside Surface	Outside Surface	Ordering Code
No finish requirement	No finish requirement	u
MP* 30μ-in 0.80μm	No finish requirement	0
MP* 30μ-in 0.80μm	MP* 30μ-in 0.80μm	3
MP* 20μ-in 0.51μm	MP* 30μ-in 0.80μm	4
MP* 12μ-in 0.30μm	MP* 30μ-in 0.80μm	7
MP* 9μ-in 0.23μm	MP* 30μ-in 0.80μm	8
Mirror	MP* 30μ-in 0.80μm	9

*MP: Mechanically Polished

Ordering Example

Description	Nominal Size DN	Ordering Code
Type 402	25	025000-402-D63*

*Material and Surface are including to the ordering code

Nomimal Size DN	A	L	T	Ordering Code
8	13.5	20	1.6	008000-400-G* **
10	17.2	28	1.6	010000-400-G* **
15	21.3	30	1.6	015000-400-G* **
20	26.9	28	1.6	020000-400-G* **
25	33.7	38	2.0	025000-400-G* **
32	42.4	48	2.0	032000-400-G* **
40	48.3	57	2.0	040000-400-G* **
50	60.3	64	2.0	050000-400-G* **
65	76.1	76	2.0	065000-400-G* **
80	88.9	86	2.3	080000-400-G* **
100	114.3	105	2.3	100000-400-G* **

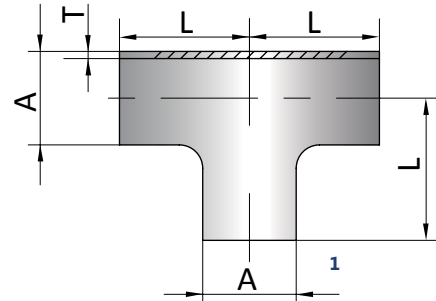

* The first digit referse to material guide, according to Table
 ** The last digit referse to surface quality, according to Table 2

Table1

Material Guide	
1.4301 (304)	3
1.4307 (304L)	4
1.4401 (316)	5
1.4404 (316L)	6

Table 2

Inside Surface	Outside Surface	Ordering Code
No finish requirement	No finish requirement	u
MP* 30μ-in 0.80μm	No finish requirement	0
MP* 30μ-in 0.80μm	MP* 30μ-in 0.80μm	3
MP* 20μ-in 0.51μm	MP* 30μ-in 0.80μm	4
MP* 12μ-in 0.30μm	MP* 30μ-in 0.80μm	7
MP* 9μ-in 0.23μm	MP* 30μ-in 0.80μm	8
Mirror	MP* 30μ-in 0.80μm	9

*MP: Mechanically Polished

Ordering Example

Description	Nomimal Size DN	Ordering Code
Type 400	25	025000-400-G63

*Material and Surface are including to the ordering code

Nominal Size DN	A	L	H	T	Ordering Code
10	13	26	9	1.5	010000-458-D* **
15	19	35	11	1.5	015000-458-D* **
20	23	40	13	1.5	020000-458-D* **
25	29	50	16	1.5	025000-458-D* **
32	35	55	19.5	1.5	032000-458-D* **
40	41	60	23	1.5	040000-458-D* **
50	53	70	30	1.5	050000-458-D* **
65	70	80	40	2.0	065000-458-D* **
80	85	90	47.5	2.0	080000-458-D* **
100	104	100	58	2.0	100000-458-D* **
125	129	187.5	74	2.0	125000-458-D* **
150	154	225	90	2.0	150000-458-D* **
200	204	300	115	2.0	200000-458-D* **

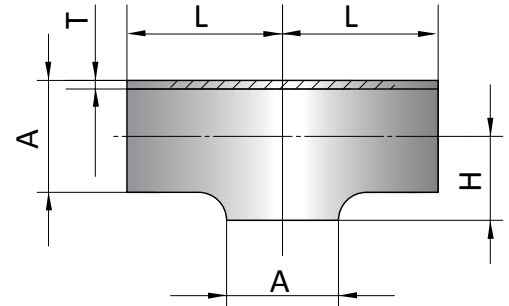

* The first digit referse to material guide, according to Table 1
 ** The last digit referse to surface quality, according to Table 2

Table1

Material Guide	
1.4301 (304)	1
1.4307 (304L)	2
1.4401 (316)	3
1.4404 (316L)	4

Table 2

Inside Surface	Outside Surface	Ordering Code
No finish requirement	No finish requirement	u
MP* 30μ-in 0.80μm	No finish requirement	0
MP* 30μ-in 0.80μm	MP* 30μ-in 0.80μm	3
MP* 20μ-in 0.51μm	MP* 30μ-in 0.80μm	4
MP* 12μ-in 0.30μm	MP* 30μ-in 0.80μm	7
MP* 9μ-in 0.23μm	MP* 30μ-in 0.80μm	8
Mirror	MP* 30μ-in 0.80μm	9

*MP: Mechanically Polished

Ordering Example

Description	Nominal Size DN	Ordering Code
Type 458	25	025000-458-D63*

*Material and Surface are including to the ordering code

Fittings

Tee Without Straight End

SEALING SYSTEMS

Nominal Size DN	A	L	H	T	Ordering Code
10	12	26	9	1.5	010000-459-D* **
15	18	35	11	1.5	015000-459-D* **
20	22	40	13	1.5	020000-459-D* **
25	28	50	16	1.5	025000-459-D* **
32	34	55	19.5	1.5	032000-459-D* **
40	40	60	23	1.5	040000-459-D* **
50	52	70	30	1.5	050000-459-D* **

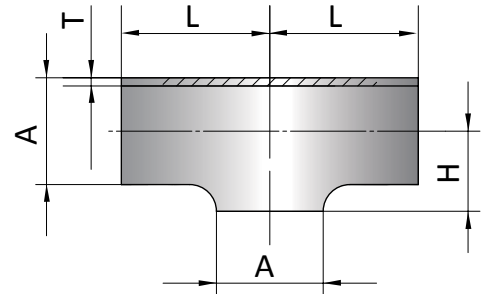

* The first digit refer to material guide, according to Table 1
 ** The last digit refer to surface quality, according to Table 2

Table 1

Material Guide	
1.4301 (304)	1
1.4307 (304L)	2
1.4401 (316)	3
1.4404 (316L)	4

Table 2

Inside Surface	Outside Surface	Ordering Code
No finish requirement	No finish requirement	u
MP* 30μ-in 0.80μm	No finish requirement	0
MP* 30μ-in 0.80μm	MP* 30μ-in 0.80μm	3
MP* 20μ-in 0.51μm	MP* 30μ-in 0.80μm	4
MP* 12μ-in 0.30μm	MP* 30μ-in 0.80μm	7
MP* 9μ-in 0.23μm	MP* 30μ-in 0.80μm	8
Mirror	MP* 30μ-in 0.80μm	9

*MP: Mechanically Polished

Ordering Example

Description	Nominal Size DN	Ordering Code
Type 459	25	025000-459-D63*

*Material and Surface are including to the ordering code